

# Těsnění pro příruby Ghibli



GHIBLI/SYSTEM

## DIMENSIONI - DIMENSIONS

### NOTE PRELIMINARI PRELIMINAR NOTES

- Foratura compatibile con flange EN 1092-1 PN 10
- Per l'accoppiamento del DN 200/250/300 consigliamo di utilizzare bulloni M18.
- Drillings suitable with flanges EN 1092-1 PN 10.
- We recommend to use bolts M18 for the connection of the DN 200/250/300.



CODIFICA/CODE: GL/P 854/90					
GUARNIZIONI GASKETS					
Diametro Interno Inner diameter mm	S mm	L mm	D1 mm	D2 mm	D3 mm
40	5.5	15	80	35	40
50	5.5	15	90	45	50
65	5.5	15	107	60	65
80	5.5	15	124	75	80
100	5.5	15	146	95	100
125	5.5	18	172	120	125
150	5.5	18	197	145	150
200	6.0	20	255	195	203
250	6.0	20	310	246	254
300	6.0	20	360	294	306

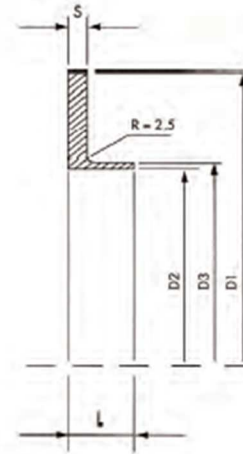

TOLLERANZE TOLERANCES	
Diametro Interno Inner diameter mm	T Sporgenza Protruding area mm
40	12 ± 3 mm
50	12 ± 3 mm
65	12 ± 3 mm
80	15 ± 3 mm
100	15 ± 3 mm
125	15 ± 3 mm
150	18 ± 3 mm
200	18 ± 3 mm
250	20 ± 3 mm
300	20 ± 3 mm